

BRITISH COLUMBIA
PLAN OF
SPUZZUM INDIAN RESERVE NO. 9.

AND
ADDITION TO SPUZZUM INDIAN RESERVE NO. 9.
TOWNSHIP 8 - RANGES 25 AND 26 - WEST OF 6TH MERIDIAN
Surveyed by J. A. Calder, D.L.S. - 13th. October, 1927.

Scale: 10 chs to an inch.

Deacon Clark
Deputy Superintendent General
of Indian Affairs
Range 26

Donald Robertson
Chief Surveyor
Dept. of Indian Affairs
Range 25.

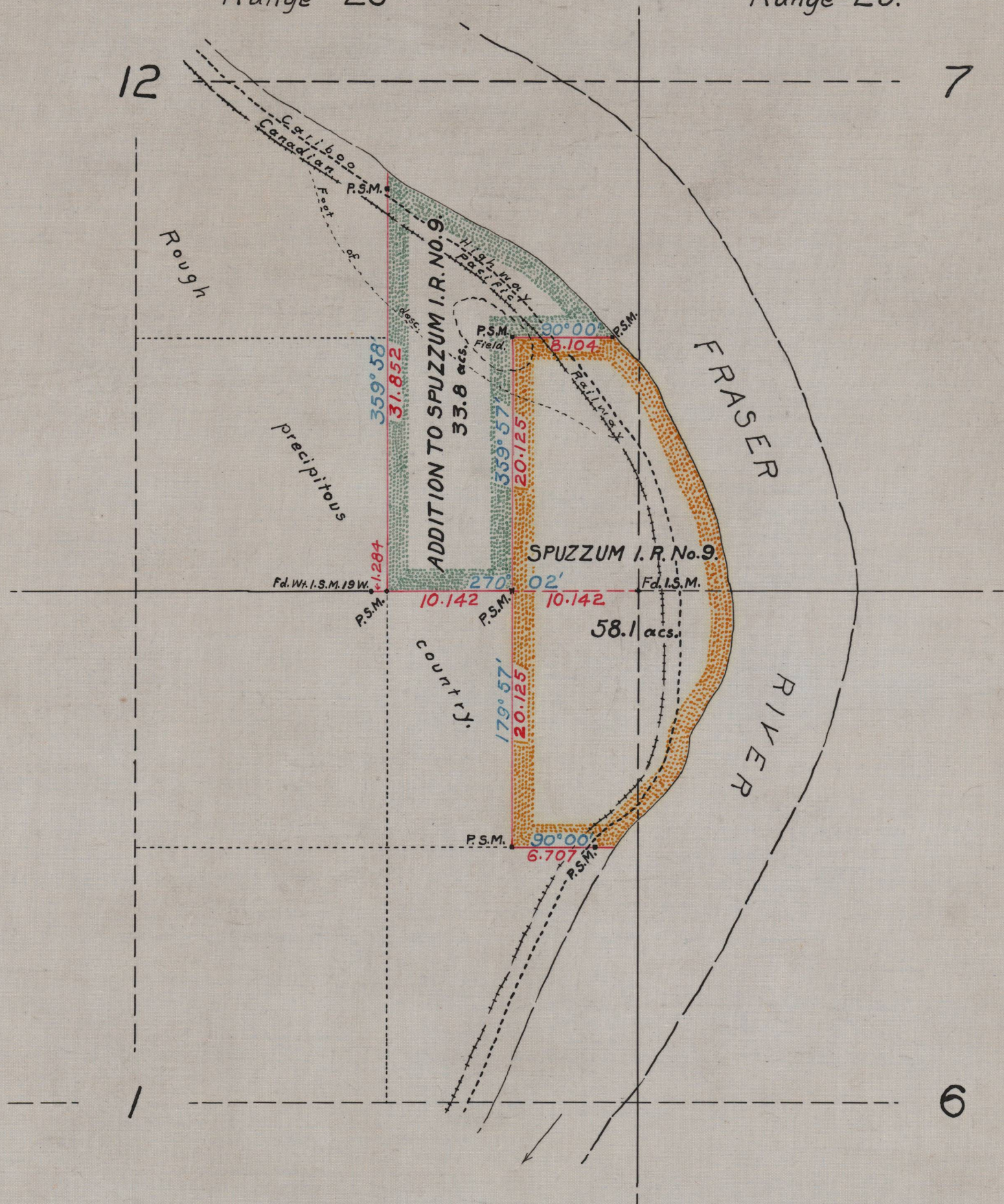

NOTE

Surveyed lines and measured distances are shown in vermillion.
Unsurveyed lines, calculated distances and bearings and previous surveys
are shown in black.

Observed bearings are shown in blue.
Distances are in chains and links.

The bearings of this survey are astronomic, expressed in degrees
and minutes and are referred to the astronomical meridian
passing through the centre of the township.

John A. Calder
D.L.S.